

EXPLANATION	
SEDIMENTARY AND METASEDIMENTARY ROCKS	IGNEOUS AND META-IGNEOUS ROCKS
Dune sand	Recent volcanic: $Qv^1$ - rhyolite; $Qv^2$ - andesite; $Qv^3$ - basalt; $Qv^4$ - pyroclastic rocks
Alluvium	
Stream channel deposits	
Fan deposits	
Basin deposits	
Salt deposits	
Quaternary lake deposits	
Glacial deposits	
Quaternary nonmarine terrace deposits	
Pleistocene marine and marine terrace deposits	Pleistocene volcanic: $Qp^1$ - rhyolite; $Qp^2$ - andesite; $Qp^3$ - basalt; $Qp^4$ - pyroclastic rocks
Pleistocene nonmarine	Quaternary and/or Pliocene cinder cones
Plio-Pleistocene nonmarine	
Undivided Pliocene nonmarine	
Upper Pliocene nonmarine	
Upper Pliocene marine	Pliocene volcanic: $Pv^1$ - rhyolite; $Pv^2$ - andesite; $Pv^3$ - basalt; $Pv^4$ - pyroclastic rocks
Middle and/or lower Pliocene nonmarine	
Middle and/or lower Pliocene marine	
Undivided Miocene nonmarine	
Upper Miocene nonmarine	
Upper Miocene marine	Miocene volcanic: $Mv^1$ - rhyolite; $Mv^2$ - andesite; $Mv^3$ - basalt; $Mv^4$ - pyroclastic rocks
Middle Miocene nonmarine	
Middle Miocene marine	
Lower Miocene marine	
Oligocene nonmarine	Oligocene volcanic: $Ov^1$ - rhyolite; $Ov^2$ - andesite; $Ov^3$ - basalt; $Ov^4$ - pyroclastic rocks
Oligocene marine	
Eocene nonmarine	
Eocene marine	Eocene volcanic: $Eo^1$ - rhyolite; $Eo^2$ - andesite; $Eo^3$ - basalt; $Eo^4$ - pyroclastic rocks
Paleocene nonmarine	
Paleocene marine	
Cenozoic nonmarine	Cenozoic volcanic: $Cv^1$ - rhyolite; $Cv^2$ - andesite; $Cv^3$ - basalt; $Cv^4$ - pyroclastic rocks
Tertiary nonmarine	Tertiary intrusive (hypabyssal) rocks: $Tt^1$ - rhyolite; $Tt^2$ - andesite; $Tt^3$ - basalt
Tertiary lake deposits	Tertiary volcanic: $Tv^1$ - rhyolite; $Tv^2$ - andesite; $Tv^3$ - basalt; $Tv^4$ - pyroclastic rocks
Tertiary marine	
Undivided Cretaceous marine	
Upper Cretaceous marine	Franciscan Formation
Lower Cretaceous marine	Franciscan volcanic and metavolcanic rocks
Knoxville Formation	Mesozoic granitic rocks: $g^1$ - granite and adamellite; $g^2$ - granodiorite; $g^3$ - tonalite and diorite
Upper Jurassic marine	Mesozoic basic intrusive rocks
Middle and/or Lower Jurassic marine	Mesozoic ultrabasic intrusive rocks
Triassic marine	Jura-Tria metavolcanic rocks
Pre-Cretaceous metamorphic rocks (ls = limestone or dolomite)	Pre-Cretaceous metamorphic rocks
Pre-Cretaceous metasedimentary rocks	Pre-Cenozoic granitic and metamorphic rocks
Paleozoic marine (ls = limestone or dolomite)	Paleozoic metamorphic rocks
Permian marine	Permian metamorphic rocks
Undivided Carboniferous marine	Carboniferous metamorphic rocks
Pennsylvanian marine	
Mississippian marine	
Devonian marine	Devonian metamorphic rocks
Silurian marine	Devonian and pre-Devonian? metamorphic rocks
Pre-Silurian metamorphic rocks	Pre-Silurian metamorphic rocks
Ordoevian marine	Pre-Silurian metamorphic rocks
Cambrian marine	Cambrian igneous and metamorphic rock complex
Cambrian - Precambrian marine	Undivided Precambrian metamorphic rocks
Undivided Precambrian metamorphic rocks	Undivided Precambrian granitic rocks
Later Precambrian sedimentary and metamorphic rocks	Precambrian anorthosite
Earlier Precambrian metamorphic rocks	

TOPOGRAPHIC BASE MAP  
Prepared by the Army Map Service (CGSO), Corps of Engineers, U.S. Army, Washington, D.C. Compiled in 1956 by U.S. Coast and Geodetic Survey by photogrammetric methods and from Arizona 1:62,500 USGS Davis Dam, 1950. Planimetric detail revised by photogrammetric methods. Horizontal and vertical control by USC&GS, USGS, and CE. Photography field annotated 1954.

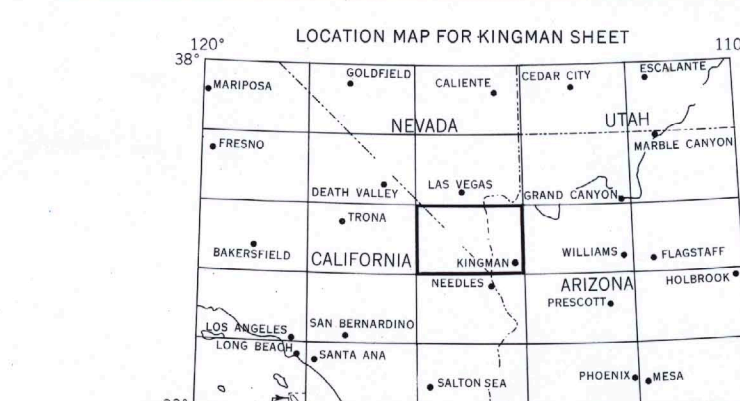

Scale 1:250,000  
20 Statute Miles  
30 Kilometers

CONTACT  
(Dashed where approximately located, gradational or inferred)

FAULT  
(Dashed where approximately located; dotted where concealed)

THRUST FAULT  
(Barbs on upper plate; dashed where approximately located; dotted where concealed)

CONTOUR INTERVAL 200 FEET  
TRANSVERSE MERCATOR PROJECTION  
**GEOLOGIC MAP OF CALIFORNIA**  
OLAF P. JENKINS EDITION  
**KINGMAN SHEET**  
COMPILATION BY CHARLES W. JENNINGS 1961  
SECOND PRINTING 1973

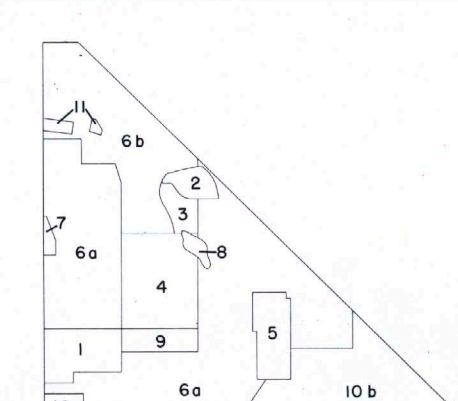

- INDEX TO GEOLOGIC MAPPING  
(COMPLETE INDEX ON EXPLANATORY SHEET)
- Barca, Richard A., unpublished
  - Clary, Michael R., unpublished
  - Dobbs, Philip H., unpublished
  - Evans, James R., unpublished
  - Haskell, Barry S., unpublished
  - Hewett, D. Foster, 1956
  - Hewett, D. Foster, 1956
  - Kupfer, Donald H., 1960
  - Olson, J. C., Shawe, D. R., Pray, L. C., and Sharp, W. P., 1954
  - Sharp, Robert P., 1957
  - Southern Pacific Company, Land Department, unpublished
  - Southern Pacific Company, Land Department, unpublished
  - Hewett, D. Foster, 1956
  - Kupfer, Donald H., 1960
  - Wright, Lauren A., unpublished

HEAVY BORDER ON BOXES INDICATES UNITS THAT APPEAR ON THIS SHEET